



PARTS CATALOG FOR MTA-4 MONSTER TRUCK

No.6218-F



**1/8 4WD NITRO
MONSTER TRUCK**

Manufactured by **THUNDER TIGER CORPORATION**

<http://www.thundertiger.com>



MTA4

1/8 4WD NITRO MONSTER TRUCK



THUNDER TIGER
PRO-21BX-R(P) ENGINE



Blue Body

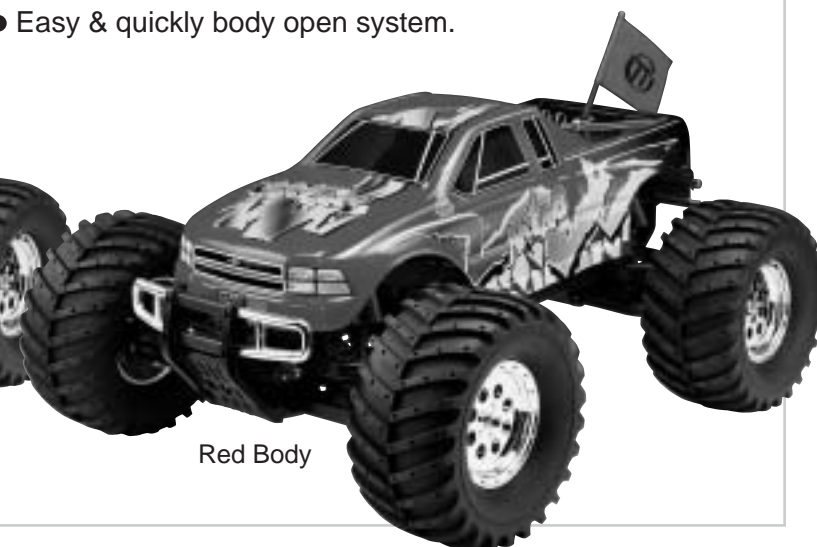

Red Body

Features

- High power and reliable .21 size engine that has two different starting methods (pull start and hex shaft start).
- A very rigid, extruded aluminum channel chassis was used to handle the stress of the long travel suspension and high power of the .21 size engine.
- Reliable, two-speed, adjustable automatic shifting, forward and reverse transmission.
- Long travel suspension is controlled by 8 adjustable oil damped shocks which handle jump heights in excess of 2 meter.
- One piece electronic equipment container unit.
- The large, non-stopping fuel tank features a dual fuel-pick-up system.
- Fuel line with primer pump.
- High impact absorbing front and rear bumpers protect the chassis and suspension during hard landings and tumbles.
- Realistic styled body shell, wheels and tires match the design of full size monster trucks.
- Easy & quickly body open system.

FRONT ASSEMBLY

NI Not Included

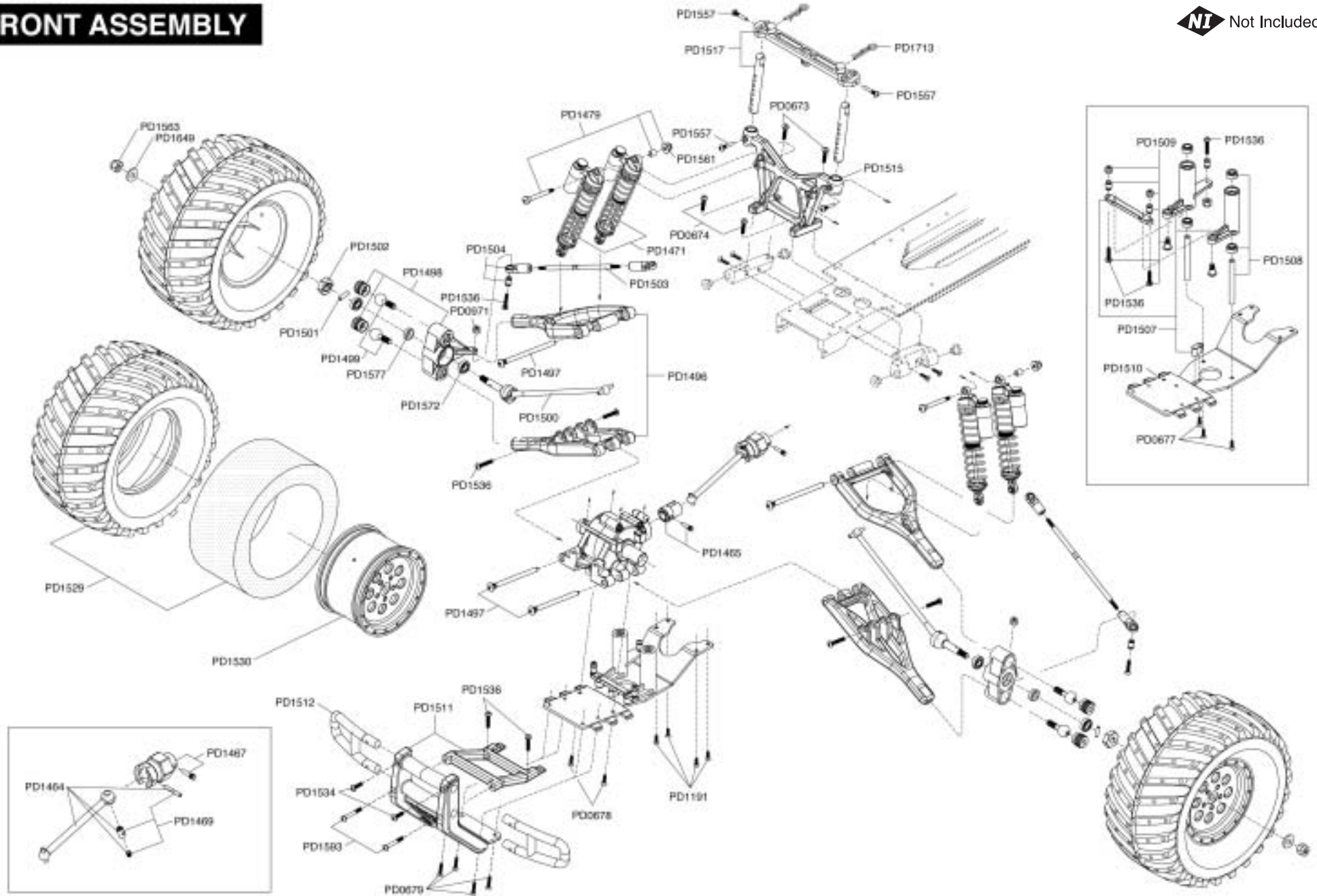

CHASSIS ASSEMBLY

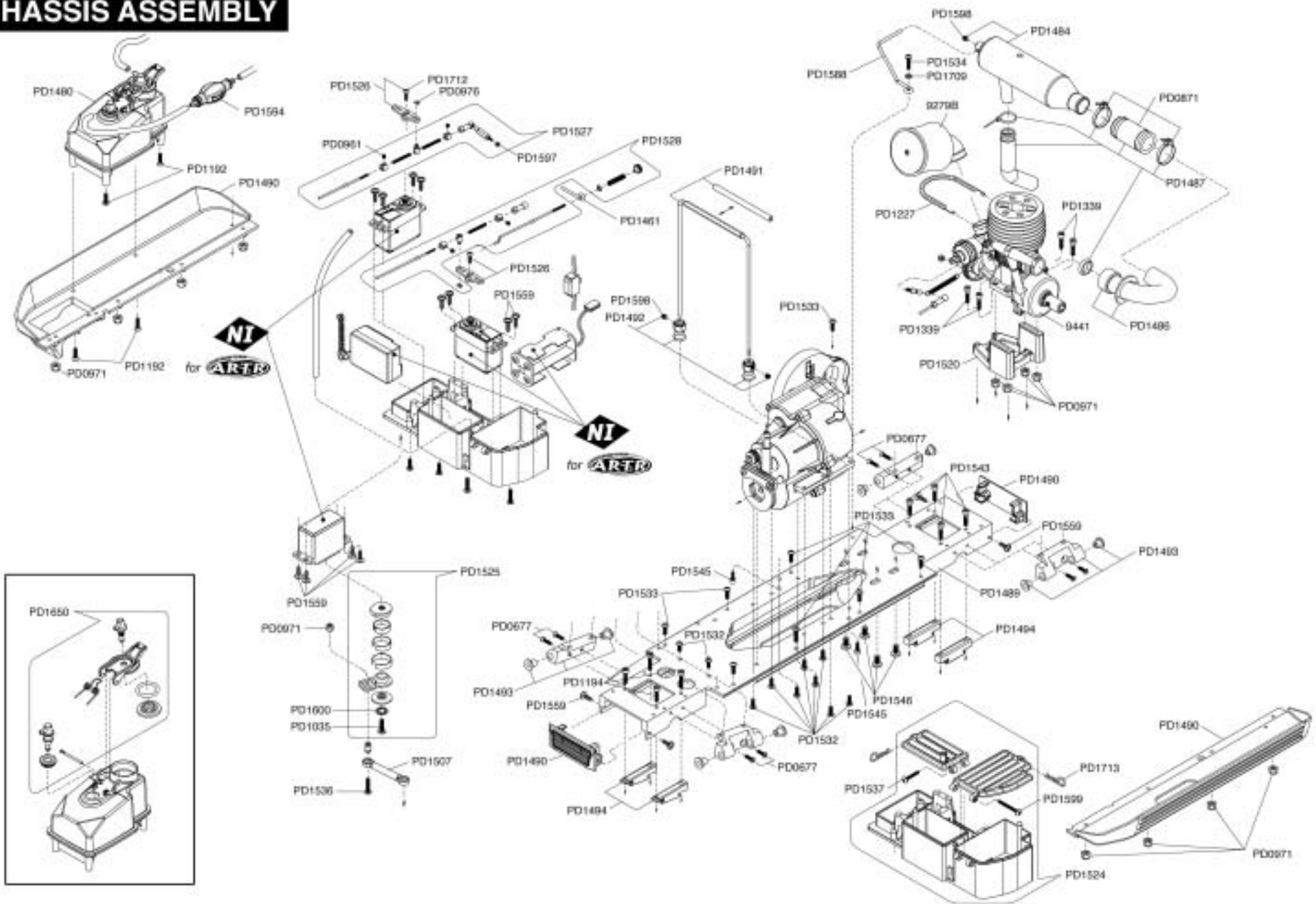

DIFF. GEAR BOX

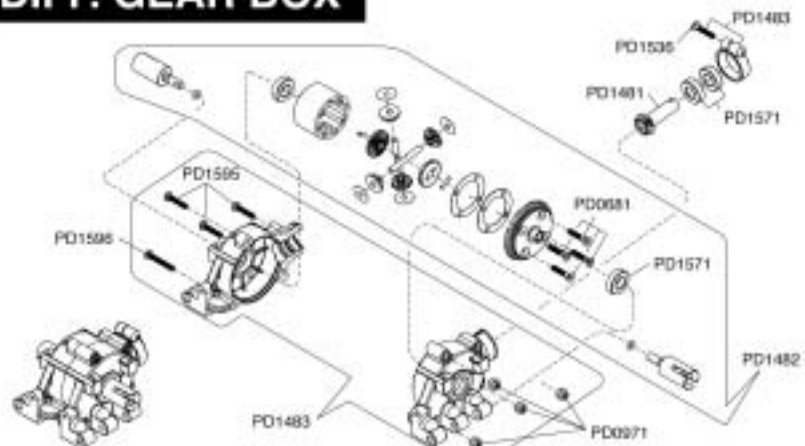

ENGINE ASSEMBLY

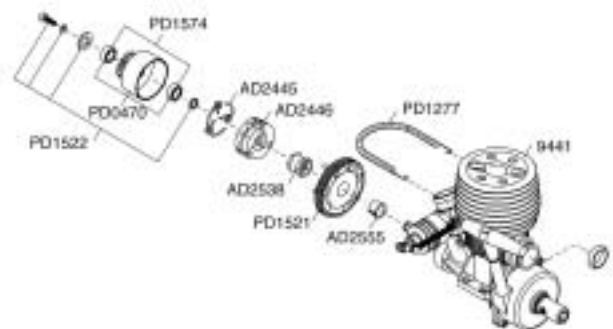

SHOCK ASSEMBLY

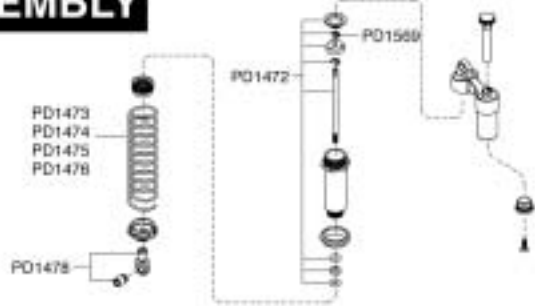

CTR TRANSMISSION GEAR BOX

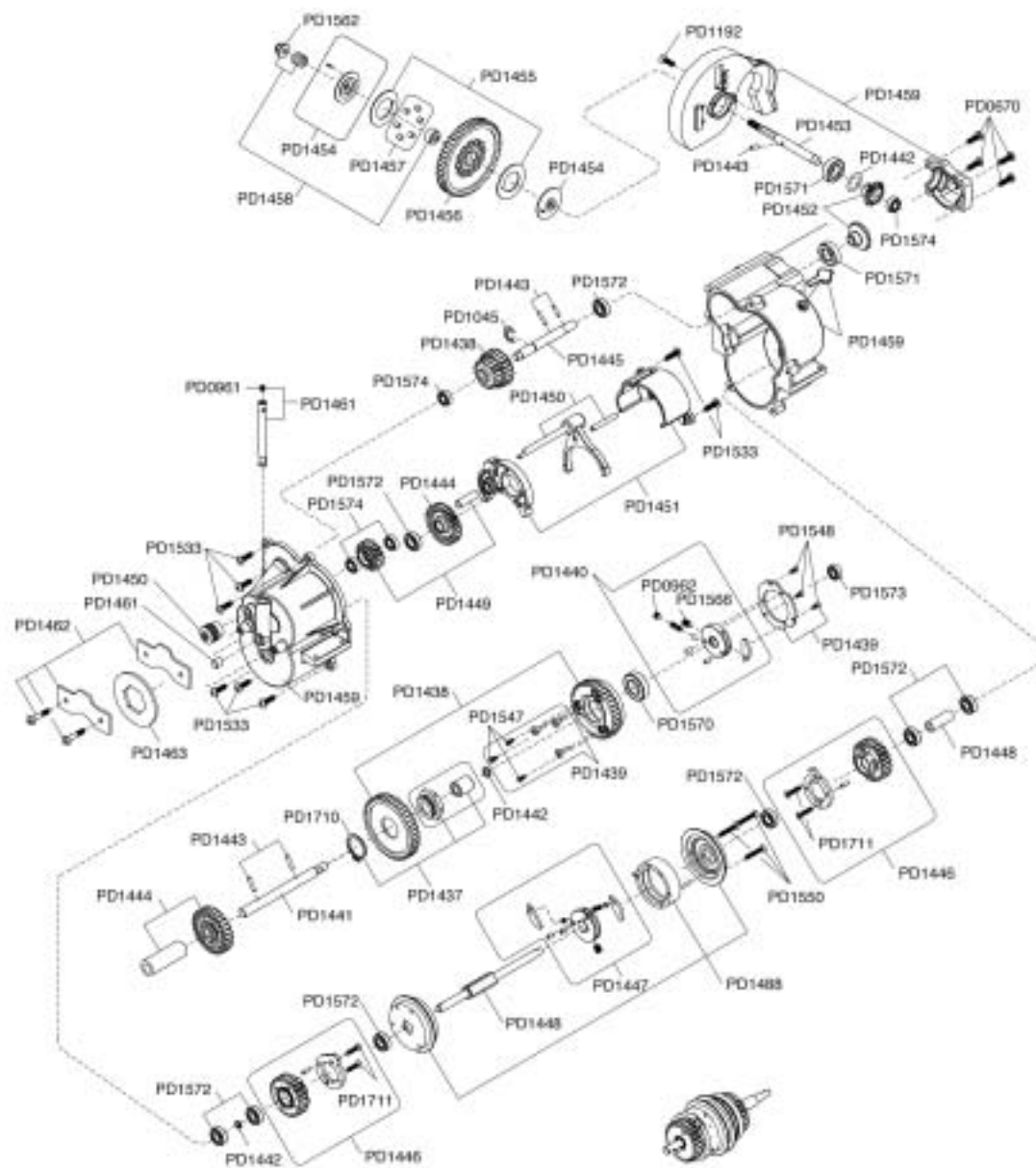

MTA-4 PARTS LIST



9279B AIR FILTER, 21 BLACK



AD2445 CLUTCH SPRING (3), 21



AD2446 CLUTCH SHOE (3), 21



AD2538 CLUTCH NUT, 21



AD2555 FLYWHEEL COLLET, 21

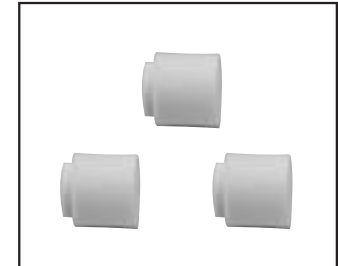

AN0747 FOAM FILTER (3), 1/8

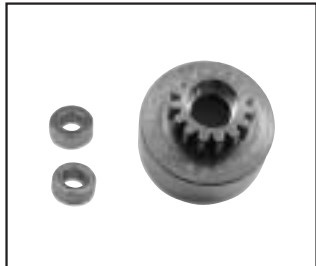

PD0470 15 TOOTH CLUTCH BELL



PD0871 COUPLER TUBE



PD1227 MANIFOLD SPRING, MTA4

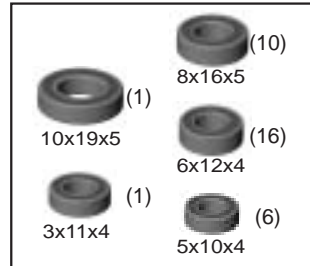

PD1436 BEARING SET, MTA4



PD1437 2 SPD ONE WAY HUB, MTA4



PD1438 2 SPD MAIN GEARS, MTA4



PD1439 SUPPORT PIN&RING, MTA4 M3X12



PD1440 2 SPD CLUTCH HUB, MTA4



PD1441 2 SPD SHAFT, MTA4



PD1442 CTR TRANS SHIM & CLIP, MTA4

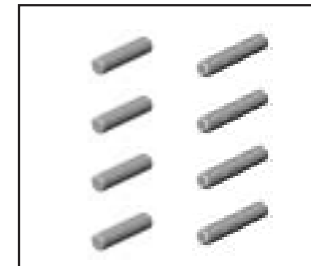

PD1443 CTR TRANS PINS, MTA4



PD1444 FWD/REV DRIVE GEARS, MTA4



PD1445 DRIVE PINION SHAFT, MTA4



PD1446 FWD/REV SHIFT GEARS, MTA4



PD1447 FWD/REV CLUTCH HUB, MTA4



PD1448 FWD/REV MAIN SHAFT, MTA4



PD1449 REV IDLE GEAR & SHAFT, MTA4



PD1450 SHIFT LEVER, MTA4

MTA-4 PARTS LIST



PD1451 REV GEAR/SHIFT FORK MNT



PD1452 BEVEL GEAR SET, MTA4



PD1453 SLIPPER SHAFT, MTA4

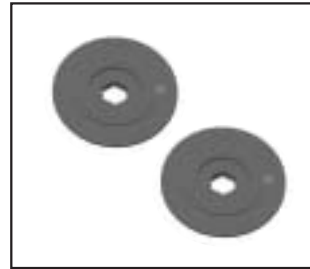

PD1454 SLIPPER HUB, MTA4

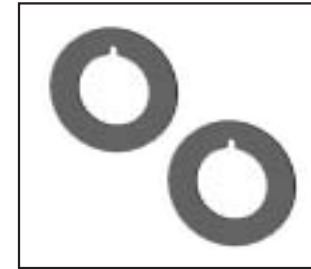

PD1455 SLIPPER RING, MTA4

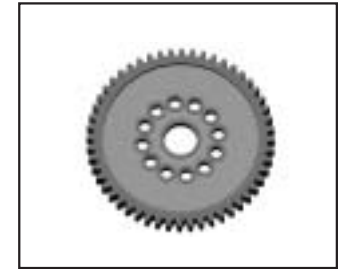

PD1456 MAIN SPUR GEAR, 52T MTA4



PD1457 SLIPPER FRICTION PEGS, MTA4



PD1458 SLIPPER HARDWARE, MTA4

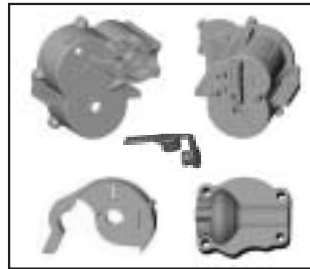

PD1459 CTR TRANSMISSION CASE, MTA4



PD1461 BRAKE CAM & HARDWARE, MTA4

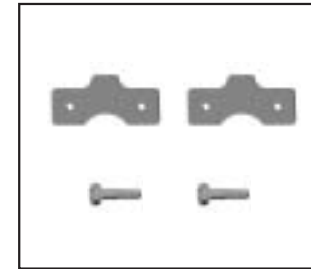

PD1462 BRAKE PADS & SCREWS, MTA4

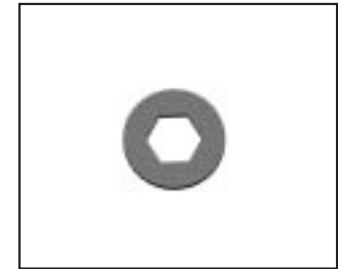

PD1463 BRAKE DISCS - MTA4



PD1464 F/R DRIVE CVA



PD1465 F/R DRIVE INPUT CUP



PD1467 F DRIVE / DISC BRAKE HUB



PD1468 REAR DRIVE OUTPUT CUP



PD1469 F/R CVA REBULID KIT



PD1471 ASSEMBLED SHOCK (2), MTA4



PD1472 SHOCK REBUILD KIT (2), MTA4

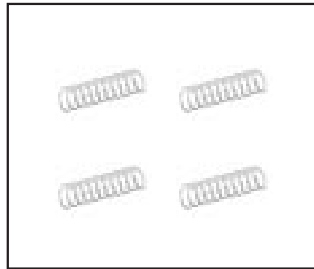

PD1473 SHOCK SPRING(4), MTA4/BL

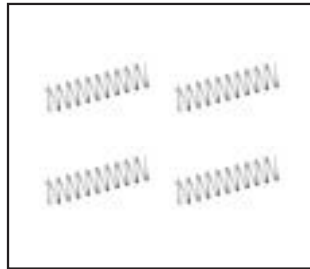

PD1474 SHOCK SPRING(4), MTA4/GL

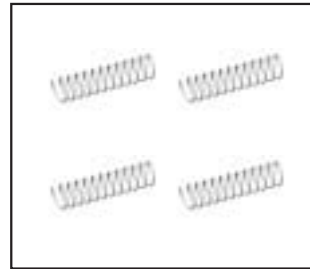

PD1475 SHOCK SPRING(4), MTA4/RED

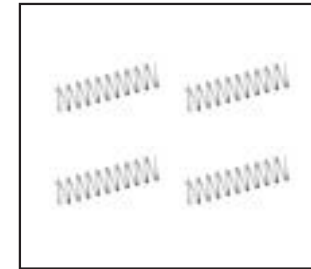

PD1476 SHOCK SPRING(4), MTA4/CU

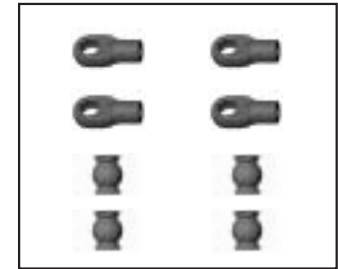

PD1478 SHOCK ENDS, MTA4

MTA-4 PARTS LIST

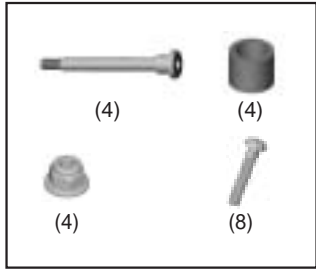

PD1479 SHOCK TOP MOUNTS, MTA4



PD1480 FUEL TANK, MTA4



PD1481 DIFF SHAFT/PINION, MTA4



PD1482 DIFF SET, MTA4



PD1483 DIFF CASE/BULKHEAD, MTA4

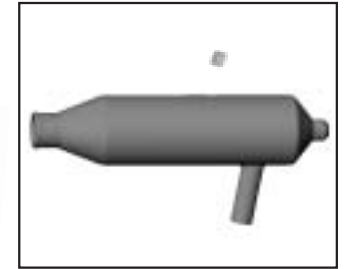

PD1484 MUFFLER, MTA4



PD1486 MANIFOLD, MTA4



PD1487 ORING, TUBE & OUTLET, MTA4



PD1488 FWD/REV CLUTCH HOU., MTA4



PD1489 CHASSIS, MTA4



PD1490 CHASSIS GUARD & COVER, MTA4



PD1491 ROLL BAR, MTA4



PD1492 ROLL BAR MOUNTS, MTA4

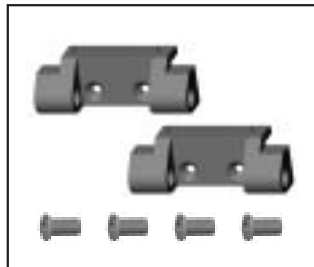

PD1493 UP SUSP. ARM MOUNTS, MTA4



PD1494 FR BULK / CHASSIS MOUNT, MTA4



PD1496 SUSP. ENSION ARM SET, MTA4

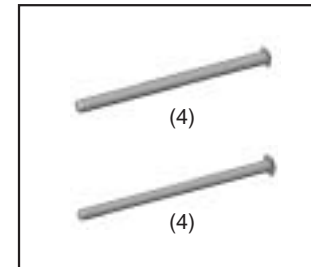

PD1497 SUSP. HINGE PIN SET, MTA4



PD1498 KNUCKLE / HUB, MTA4

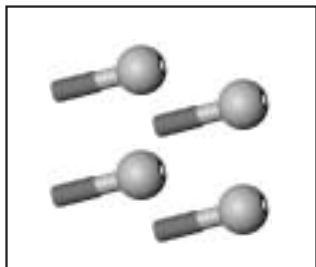

PD1499 ADJUST BALL (4), 10.8mm



PD1500 BALL TYPE UNIVERSAL, MTA4



PD1501 STEEL PIN (4), 2.5X5mm



PD1502 WHEEL HEX DRIVE (4), MTA4

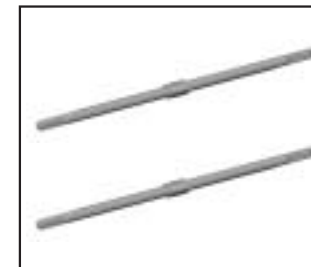

PD1503 FR TURNBUCKLE, 4X110mm

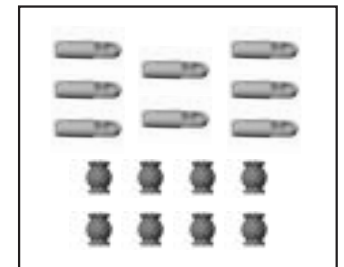

PD1504 F/R TURNBUCKLE END, MTA4

MTA-4 PARTS LIST



PD1505 RR TURNBUCKLE, M4X126mm



PD1507 BELLCRANK PL. PARTS, MTA4

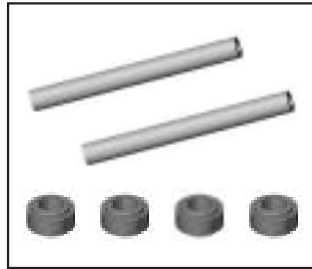

PD1508 BELLCRANK POST & BUSH., MTA4

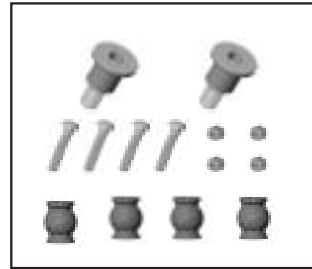

PD1509 BELLCRANK HARDWARE, MTA4



PD1510 FR SKID PLATE, MTA4



PD1511 FR BUMPER & BRACE, MTA4



PD1512 FR&RR BUMPER, MTA4



PD1513 RR BUMPER & BRACE, MTA4



PD1514 RR SKID PLATE, MTA4



PD1515 FR SHOCK TOWER, MTA4



PD1516 RR SHOCK TOWER, MTA4

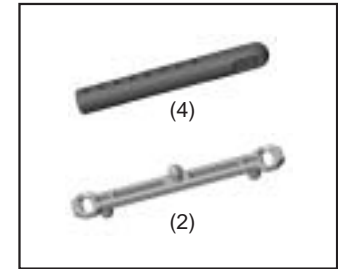

PD1517 BODY MOUNTS & POSTS, MTA4



PD1518 RR CLIP&FLAG MOUNT, MTA4



PD1519 RR FLAG & POSTS, MTA4



PD1520 ENGINE MOUNT, MTA4



PD1521 3-SHOE FAN FLYWHEEL, 21

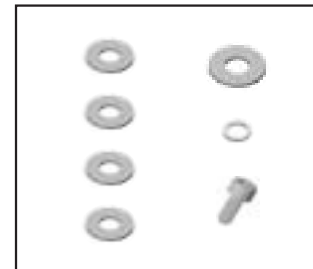

PD1522 CLUTCH HARDWARE, 21

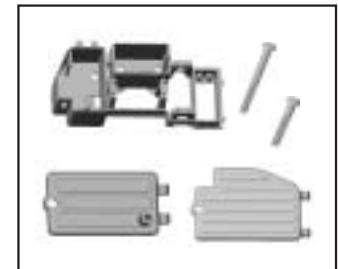

PD1524 RADIO TRAY, MTA4



PD1525 SERVO SAVER, MTA4



PD1526 SERVO HORNS, MTA4

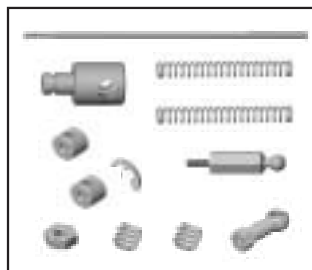

PD1527 GEAR SHIFT LINKAGE, MTA4

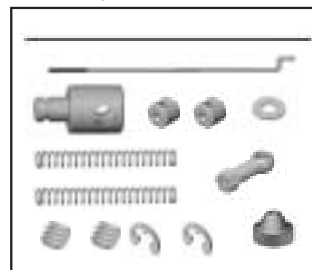

PD1528 THRO./BRAKE LINKAGE, MTA4

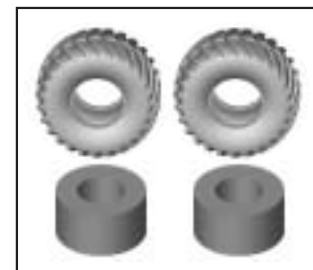

PD1529 TIRES (2), MTA4



PD1530 WHEELS (2), MTA4

MTA-4 PARTS LIST



PD1570 BALL BEARING(2),
10X19X5



PD1571 BALL BEARING(2),
8X16X5

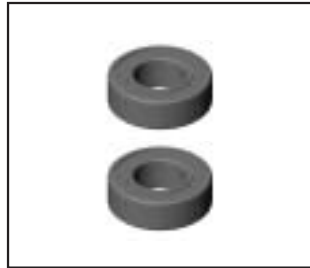

PD1572 BALL BEARING(2),
6X12X4



PD1573 BALL BEARING(2),
5X11X4



PD1574 BALL BEARING(2),
5X10X4

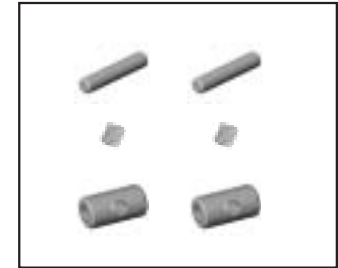

PD1575 UNIV. REBUILD KIT,
MTA4

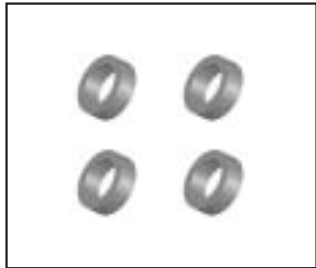

PD1577 AXLE BEARING
SAPCER



PD1588 MUFFLER MNT. WIRE,
MTA4



PD1589 PRINTED BODY (RED),
MTA4



PD1594 FUEL PRIMER PUMP



PD1650 FUEL TANK ACC, MTA

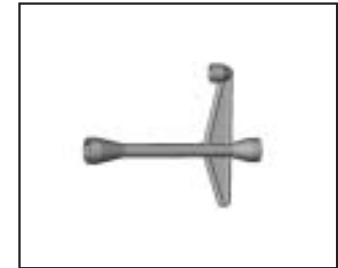

PD1714 NUT WRENCE

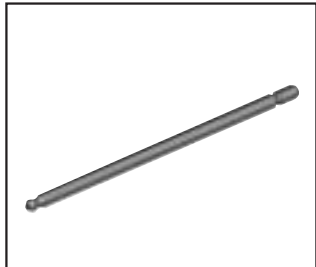

PD1715 BALL HEX DRIVE SHAFT,
6mm



PD1716 PRINTED BODY (BLUE),
MTA4

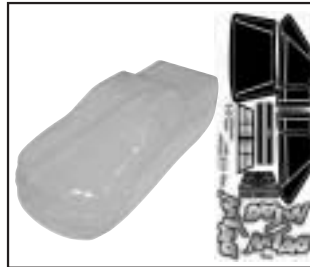

PD1717 CLEAR BODY W/ DECAL,
MTA4



PD1557 BODY POST MOUNT
SCREWS (20), MTA4

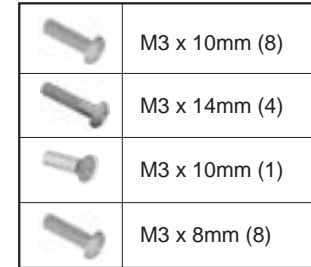

PD1460 CTR TRANS CASE
SCREWS, MTA4

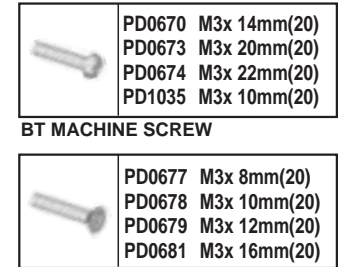

PD0670 M3x 14mm(20)
PD0673 M3x 20mm(20)
PD0674 M3x 22mm(20)
PD1035 M3x 10mm(20)

BT MACHINE SCREW

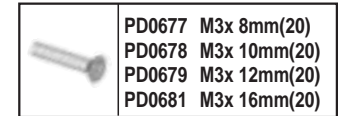

PD0677 M3x 8mm(20)
PD0678 M3x 10mm(20)
PD0679 M3x 12mm(20)
PD0681 M3x 16mm(20)

CT MACHINE SCREW

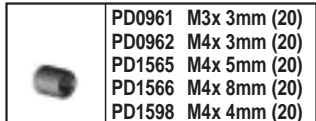

PD0961 M3x 3mm (20)
PD0962 M4x 3mm (20)
PD1565 M4x 5mm (20)
PD1566 M4x 8mm (20)
PD1598 M4x 4mm (20)

SET SCREW

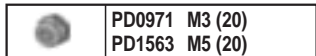

PD0971 M3 (20)
PD1563 M5 (20)

LOCK NUT

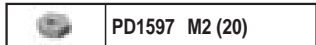

PD1597 M2 (20)

NUT

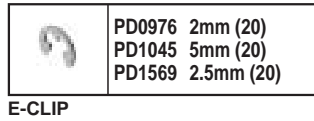

PD0976 2mm (20)
PD1045 5mm (20)
PD1569 2.5mm (20)

E-CLIP

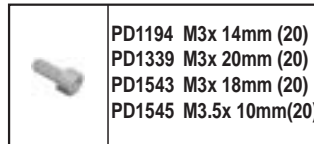

PD1194 M3x 14mm (20)
PD1339 M3x 20mm (20)
PD1543 M3x 18mm (20)
PD1545 M3.5x 10mm(20)

SK H.M. SCREW

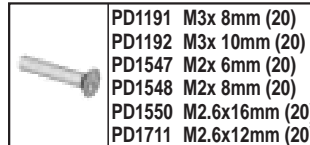

PD1191 M3x 8mm (20)
PD1192 M3x 10mm (20)
PD1547 M2x 6mm (20)
PD1548 M2x 8mm (20)
PD1550 M2.6x16mm (20)
PD1711 M2.6x12mm (20)

CT PHILLIP MACHINE SCREW



PD1546 M5x 10mm (20)

FLAT HEAD SOCKET SCREW

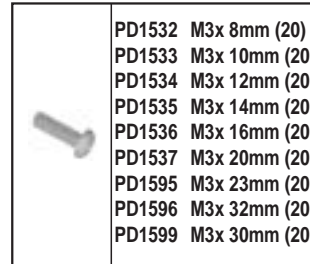

PD1532 M3x 8mm (20)
PD1533 M3x 10mm (20)
PD1534 M3x 12mm (20)
PD1535 M3x 14mm (20)
PD1536 M3x 16mm (20)
PD1537 M3x 20mm (20)
PD1595 M3x 23mm (20)
PD1596 M3x 32mm (20)
PD1599 M3x 30mm (20)

BT PHILLIP MACHINE SCREW

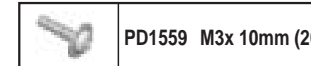

PD1559 M3x 10mm (20)

BTW PHILLIP TAP SCREW

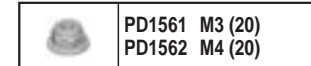

PD1561 M3 (20)
PD1562 M4 (20)

LOCK NUT WITH FLANGE

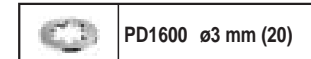

PD1600 ø3 mm (20)

LOCK WASHER

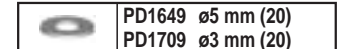

PD1649 ø5 mm (20)
PD1709 ø3 mm (20)

WASHER

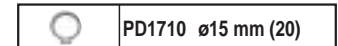

PD1710 ø15 mm (20)

"C" CLIP

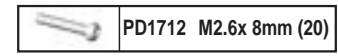

PD1712 M2.6x 8mm (20)

BT PHILLIP TAP SCREW

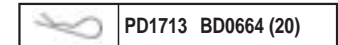

PD1713 BD0664 (20)

BODY CLIP

9441 PRO-21BX-R(P) PARTS LIST

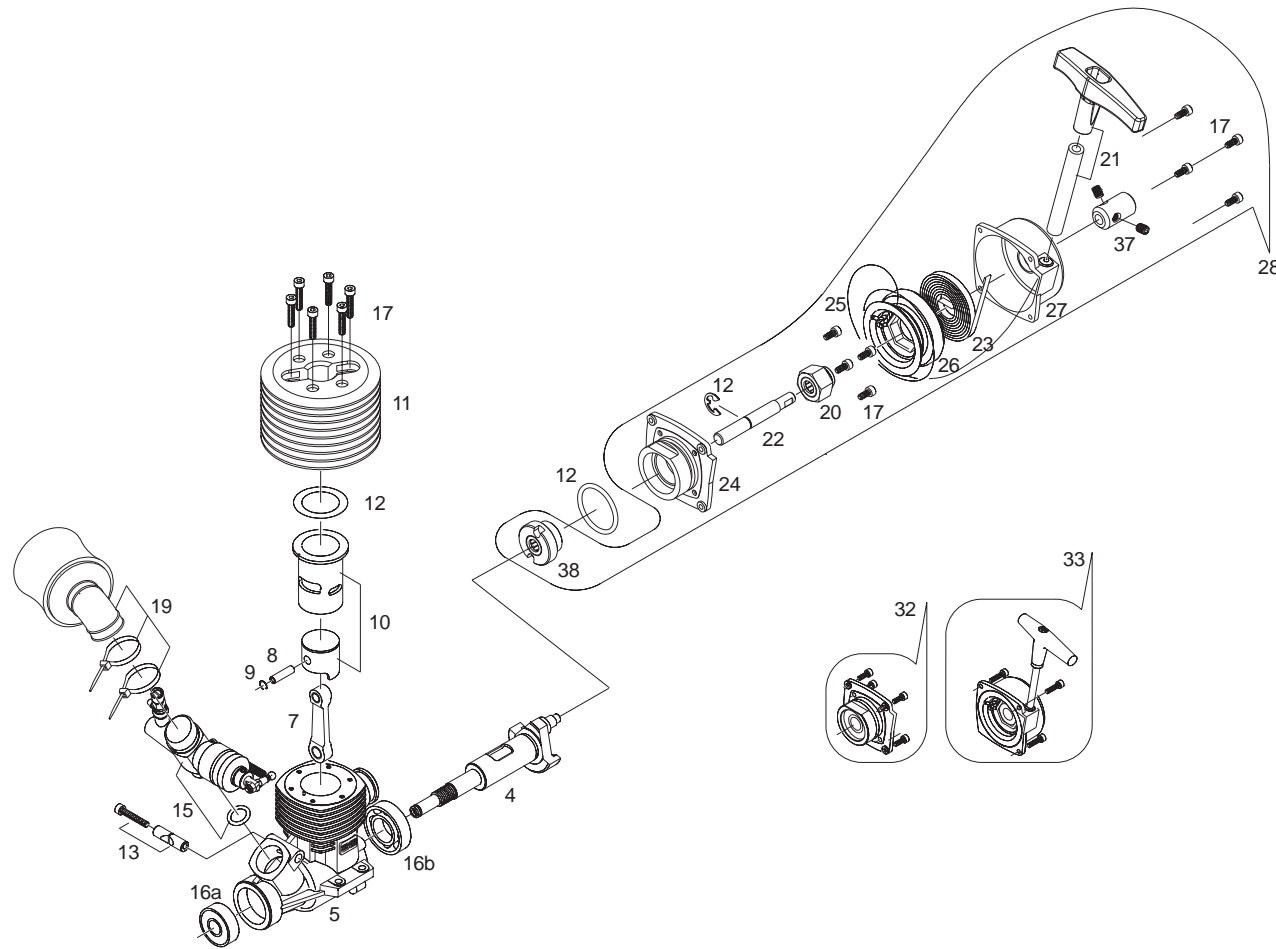

NO.	PART#	DESCRIPTION	NOTE
1	*****	PROP NUT	
3	*****	DRIVE WASHER SET	
4	AA0265	CRANKSHAFT	
5	AN0971	CRANKCASE	
6	*****	BACKPLATE	
7	AN0349	CONNECTING ROD	
8	AA0350	WRIST PIN ASSEMBLY	
9	AA0351	CIRCLIP	
10	AN0549	CYLINDER & PISTON	
11	AA0354R	CYLINDER HEAD	
12	PN0232	GASKET SET	
13	AN0356	CARB RETAINING BOLT	
15	9745	CARBURETOR ASSEMBLY	
16a	AMV607Z	BALL BEARING, FRONT	
16b	AMV6901X	BALL BEARING, REAR	
17	PN0060	SCREW SET	
19	9279B	AIR CLEANER SET	
20	AN0992	ONE WAY CLUTCH SET	
21	PN0233	HANDLE SET	
22	AA0995	STARTING AXLE	
23	AA0994	STARTING SPRING	
24	AN0989	BACKPLATE	
25	AA0972	STARTING WHEEL WIRE	
26	AA0097	STARTING WHEEL	
27	AN0993	STARTING WHEEL COVER	
28	PN0234	STARTING SET	
32	PN0235	BACKPLATE & SCREW SET	
33	PN0236	STARTING WHEEL COVER SET	
35	PN1486	EXHAUST HEADER PIPES	
37	PV0026	STARTER COUPLING	
38	AN0990	ONE WAY CLUTCH SET	



MTA-4 1/8 4WD NITRO MONSTER TRUCK SPARE PARTS LIST

AUG 2003

PART#	DESCRIPTION	NOTE
9279B	AIR FILTER, 21 BLACK	
AD2445	CLUTCH SPRING (3), 21	
AD2446	CLUTCH SHOE (3), 21	
AD2538	CLUTCH NUT, 21	
AD2555	FLYWHEEL COLLET, 21	
AN0747	FOAM FILTER(3), 1/8	
PD0470	15 TOOTH CLUTCH BELL	
PD0670	BT H.M SCREW(20), M3X14	
PD0673	BT H.M SCREW (20), M3X20	
PD0674	BT H.M SCREW (20), M3X22	
PD0677	CT H.M SCREW (20), M3X8	
PD0678	CT H.M SCREW (20), M3X10	
PD0679	CT H.M SCREW (20), M3X12	
PD0681	CT H.M SCREW (20), M3X16"	
PD0871	COUPLER TUBE	
PD0961	SET SCREW (20), M3X3	
PD0962	SET SCREWS(20), M4X3	
PD0971	LOCK NUT (20), M3	
PD0976	E-CLIP (20), 2mm	
PD1035	BT HEX MACHINE SCREW (20), 3X10mm	
PD1045	E-CLIP (20), 5mm	
PD1191	CT P.M. SCREW (20), M3X8	
PD1192	CT P.M. SCREW (20), M3X10	
PD1194	SK H.M SCREW (20), M3X14	
PD1227	MANIFOLD SPRING, MTA4	
PD1339	SK H.M SCREW (20), M3X20	
PD1436	BEARING SET, MTA4	
PD1437	2 SPD ONE WAY HUB, MTA4	
PD1438	2 SPD MAIN GEARS, MTA4	
PD1439	SUPPORT PIN&RING, MTA4	
PD1440	2 SPD CLUTCH HUB, MTA4	
PD1441	2 SPD SHAFT, MTA4	
PD1442	CTR TRANS SHIM&CLIP, MTA4	
PD1443	CTR TRANS PINS, MTA4	
PD1444	FWD/REV DRIVE GEARS, MTA4	
PD1445	DRIVE PINION SHAFT, MTA4	
PD1446	FWD/REV SHIFT GEARS, MTA4	
PD1447	FWD/REV CLUTCH HUB, MTA4	
PD1448	FWD/REV MAIN SHAFT, MTA4	
PD1449	REV IDLE GEAR&SHAFT, MTA4	

PART#	DESCRIPTION	NOTE
PD1450	SHIFT LEVER, MTA4	
PD1451	REV GEAR/SHIFT FORK MNT	
PD1452	BEVEL GEAR SET, MTA4	
PD1453	SLIPPER SHAFT, MTA4	
PD1454	SLIPPER HUB, MTA4	
PD1455	SLIPPER RING, MTA4	
PD1456	MAIN SPUR GEAR, 52T MTA4	
PD1457	SLIPPER FRICTION PEGS, MTA4	
PD1458	SLIPPER HARDWARE, MTA4	
PD1459	CTR TRANSMISSION CASE, MTA4	
PD1460	CTR TRANS CASE SCREWS, MTA4	
PD1461	BRAKE CAM & HARDWARE, MTA4	
PD1462	BRAKE PADS & SCREWS, MTA4	
PD1463	BRAKE DISCS - MTA4	
PD1464	F/R DRIVE CVA	
PD1465	F/R DRIVE INPUT CUP	
PD1467	F DRIVE / DISC BRAKE HUB	
PD1468	REAR DRIVE OUTPUT CUP	
PD1469	F/R CVA REBULID KIT	
PD1471	ASSEMBLED SHOCK(2), MTA4	
PD1472	SHOCK REBUILD KIT(2), MTA4	
PD1473	SHOCK SPRING(4), MTA4/BL	
PD1474	SHOCK SPRING(4), MTA4/GL	
PD1475	SHOCK SPRING(4), MTA4/RED	
PD1476	SHOCK SPRING(4), MTA4/CU	
PD1478	SHOCK ENDS, MTA4	
PD1479	SHOCK TOP MOUNTS, MTA4	
PD1480	FUEL TANK, MTA4	
PD1481	DIFF SHAFT/PINION, MTA4	
PD1482	DIFF SET, MTA4	
PD1483	DIFF CASE/BULKHEAD, MTA4	
PD1484	MUFFLER, MTA4	
PD1486	MANIFOLD, MTA4	
PD1487	ORING, TUBE&OUTLET, MTA4	
PD1488	FWD/REV CLUTCH HOU., MTA4	
PD1489	CHASSIS, MTA4	
PD1490	CHASSIS GUARD&COVER, MTA4	
PD1491	ROLL BAR, MTA4	
PD1492	ROLL BAR MOUNTS, MTA4	
PD1493	UP SUSP. ARM MOUNTS, MTA4	

PART#	DESCRIPTION	NOTE
PD1494	FR BULK / CHASSIS MOUNT, MTA4	
PD1496	SUSPENSION ARM SET, MTA4	
PD1497	SUSP. HINGE PIN SET, MTA4	
PD1498	KNUCKLE / HUB, MTA4	
PD1499	ADJUST BALL (4), 10,8mm	
PD1500	BALL TYPE UNIVERSAL, MTA4	
PD1501	STEEL PIN (4), 2.5X5mm	
PD1502	WHEEL HEX DRIVE (4), MTA4	
PD1503	TURNBUCKLE, 4X110mm	
PD1504	F/R TURNBUCKLE END, MTA4	
PD1505	TURNBUCKLE, M4X126mm	
PD1507	BELLCRANK PL. PARTS, MTA4	
PD1508	BELLCRANK POST&BUSH., MTA4	
PD1509	BELLCRANK HARDWARE, MTA4	
PD1510	FR SKID PLATE, MTA4	
PD1511	FR BUMPER & BRACE, MTA4	
PD1512	FR&RR BUMPER, MTA4	
PD1513	RR BUMPER & BRACE, MTA4	
PD1514	RR SKID PLATE, MTA4	
PD1515	FR SHOCK TOWER, MTA4	
PD1516	RR SHOCK TOWER, MTA4	
PD1517	BODY MOUNTS&POSTS, MTA4	
PD1518	RR CLIP&FLAG MOUNT, MTA4	
PD1519	RR FLAG & POSTS, MTA4	
PD1520	ENGINE MOUNT, MTA4	
PD1521	3-SHOE FAN FLYWHEEL, 21	
PD1522	CLUTCH HARDWARE, 21	
PD1524	RADIO TRAY, MTA4	
PD1525	SERVO SAVER, MTA4	
PD1526	SERVO HORNS, MTA4	
PD1527	GEAR SHIFT LINKAGE, MTA4	
PD1528	THRO./ BRAKE LINKAGE, MTA4	
PD1529	TIRES (2), MTA4	
PD1530	WHEELS (2), MTA4	
PD1532	BT P.M. SCREW (20), M3X8	
PD1533	BT P.M. SCREW (20), M3X10	
PD1534	BT P.M. SCREW (20), M3X12	
PD1535	BT P.M. SCREW (20), M3X14	
PD1536	BT P.M. SCREW (20), M3X16	
PD1537	BT P.M. SCREW (20), M3X20	



MTA-4 1/8 4WD NITRO MONSTER TRUCK PARTS LIST

AUG 2003

PART#	DESCRIPTION	NOTE
PD1538	BT P.M. SCREW (20), M3X22	
PD1543	SK H.M SCREW (20), M3X18	
PD1545	SK H.M SCREW (20), M3.5X10	
PD1546	FLAT HEAD SOCKET SCREW (20), M5X10	
PD1547	CT P.M. SCREW (20), M2X6	
PD1548	CT P.M. SCREW (20), M2X8	
PD1549	CT P.M. SCREW (20), M2.6X10	
PD1550	CT P.M. SCREW (20), M2.6X16	
PD1557	BODY POST MT. SCREWS, MTA4	
PD1558	BTW P.T. SCREW (20), M3X8	
PD1559	BTW P.T. SCREW (20), M3X10	
PD1561	LOCK NUT (20), FLANGE M3	
PD1562	LOCK NUT (20), FLANGE M4	
PD1563	LOCK NUT (20), FLANGE M5	
PD1565	SET SCREW (20), 4X5mm	
PD1566	SET SCREW (20), 4X8mm	
PD1567	SET SCREW (20), 5X4mm	
PD1569	E-CLIP (20), 2.5mm	
PD1570	BALL BEARING(2), 10X19X5	
PD1571	BALL BEARING(2), 8X16X5	
PD1572	BALL BEARING(2), 6X12X4	
PD1573	BALL BEARING(2), 5X11X4	
PD1574	BALL BEARING(2), 5X10X4	

PART#	DESCRIPTION	NOTE
PD1575	UNIV. REBUILD KIT, MTA4	
PD1577	AXLE BEARING SAPCER	
PD1588	MUFFLER MNT. WIRE, MTA4	
PD1589	PRINTED BODY (RED), MTA4	
PD1593	SHOULDER SCREW, M3X22	
PD1594	FUEL PRIMER PUMP	
PD1595	BT H.M SCREW(20), M3X23	
PD1596	BT H.M SCREW(20), M3X32	
PD1597	NUT(20), M2	
PD1598	SET SCREWS(20), M4X4	
PD1599	BT H.M SCREW(20), M3X30	
PD1600	LOCK WASHER(20), 5mm	
PD1649	WASHER (20), 5mm	
PD1650	FUEL TANK ACC, MTA4	
PD1709	WASHER (20), 3mm	
PD1710	"C" CLIP(20), M15	
PD1711	CT P.M. SCREW (20), M2.6X12	
PD1712	BT PHILLIP TAP SCREW (20), M2.6X8	
PD1713	BODY CLIPS (20)	
PD1714	NUT WRENCE	
PD1715	BALL HEX DRIVE SHAFT, 6mm	
PD1716	PRINTED BODY (BLUE), MTA4	
PD1717	CLEAR BODY W/ DECAL, MTA4	

OPTIONAL PARTS LIST

PART#	DESCRIPTION	NOTE
PD0418	1/8 TUNED PIPE, C2A	
PD1523	CLUTCH BELL 14T	
PD1582	SERVO SAVER, HITECH	
PD1583	SERVO SAVER, JR	
PD1751	CLUTCH BELL 16T	
PD1752	CLUTCH BELL 17T	
PD1753	CLUTCH BELL 18T	
PD1754	SPUR GEAR 49T	
PD1755	SPUR GEAR 46T	
PD1756	TI ALLOY STEERING LINK ROD	
PD1757	TI ALLOY REAR LINK ROD	
PD1759	OPTIONAL MACHINED CHASSIS	
AA0094	OPTIONAL MACHINED CYLINDER HEAD	
PD1761	5MM LOCK NUT, BLUE ALUM	
PD1304	4MM LOCK NUT, BLUE ALUM	
PD1301	3MM LOCK NUT, BLUE ALUM	
PD1762	OPTIONAL STEERING KIT	
PD1763	OPT. STEERING RACK/ARM	
PD1764	SERVO SAVER HUB/SPRING	
PD1765	OPT STEERING HARDWARE	
PD1766	WHEEL HEX DRIVER, BLUE	
PD1767	METAL SHOCK BODY	
PD1769	SIDE MOUNT EXHAUST MANIFOLD	
PD1770	SIDE EXHAUST MUFFLER MOUNT	
PD1771	VENTILATED BRAKE DISC	
PD1774	REVERSE ELIMINATION KIT	

MTA-4 MONSTER TRUCK OPTIONAL PARTS LIST

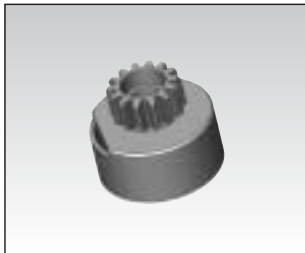

PD1753 CLUTCH BELL 14T

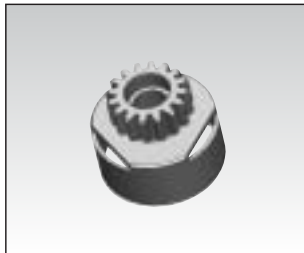

PD1751 CLUTCH BELL 16T



PD1752 CLUTCH BELL 17T

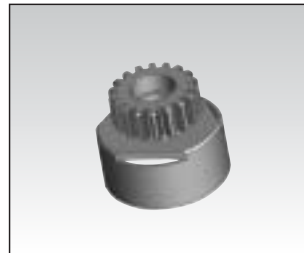

PD1753 CLUTCH BELL 18T

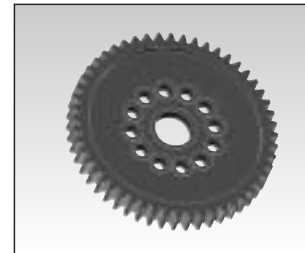

PD1754 SPUR GEAR 49T

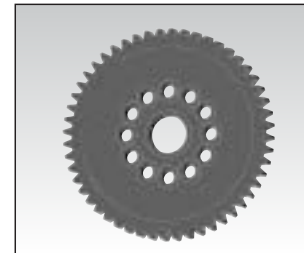

PPD1755 SPUR GEAR 46T

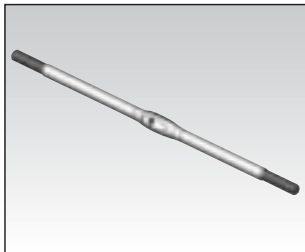

PD1756 TI ALLOY STEERING LINK ROD



PD1757 TI ALLOY REAR LINK ROD-

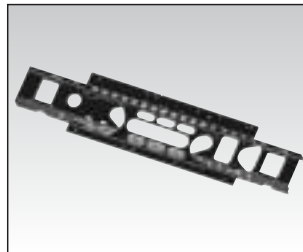

PD1759 OPTIONAL MACHINED CHASSIS

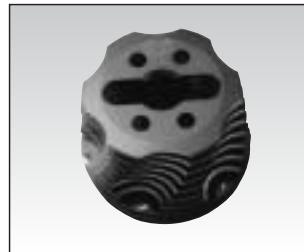

AA0094 OPTIONAL MACHINED CYLINDER HEAD

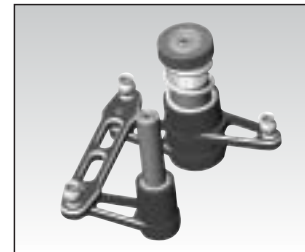

PD1762 OPTIONAL STEERING KIT

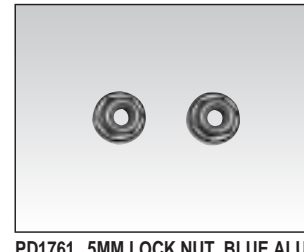

PD1761 5MM LOCK NUT, BLUE ALUM
PD1304 4MM LOCK NUT, BLUE ALUM
PD1301 3MM LOCK NUT, BLUE ALUM



PD1763 OPT. STEERING RACK/ARM



PD1764 SERVO SAVER HUB/SPRING

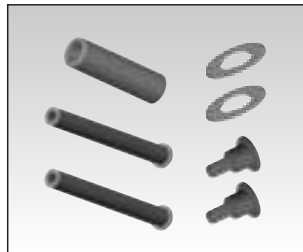

PD1765 OPT STEERING HARDWARE

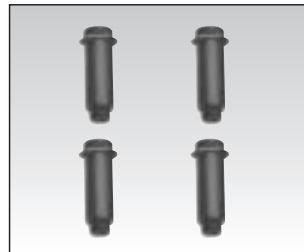

PD1767 METAL SHOCK BODY

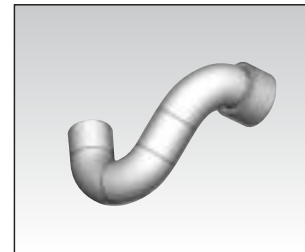

PD1769 SIDE MOUNT EXHAUST MANIFOLD

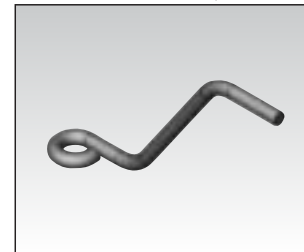

PD1770 SIDE EXHAUST MUFFLER MOUNT

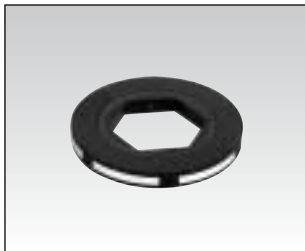

PD1771 VENTILATED BRAKE DISC

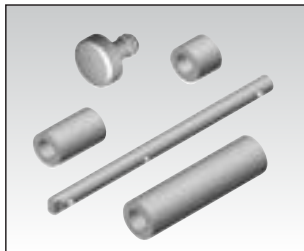

PD1774 REVERSE ELIMINATION KIT

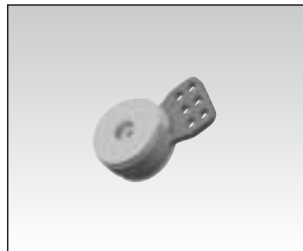

PD1582 SERVO SAVER, HITECH

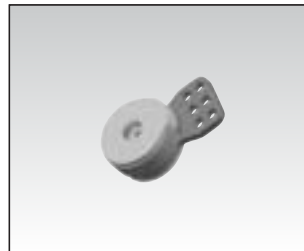

PD1583 SERVO SAVER, JR

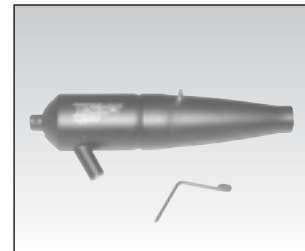

PD0418 1/8 TUNED PIPE

-
- 1) **PRO-21BX-R(P) Rear exhaust engine**
 - 2) **Rigid, extruded aluminum channel chassis with front 9 degree kick-up**
 - 3) **High impact absorbing front and rear bumpers.**
 - 4) **2 speed forward and reverse transmission**
 - 5) **Extra long travel suspension arms**
 - 6) **8 Oil-Filled Type shock absorbers**
 - 7) **Realistic styled oversize monster truck wheels and tires**
 - 8) **Dual-function starting system (pull start and hex start)**
 - 9) **Massive single-disc brake system**
 - 10) **•nic equipment container unit.**